

10 096 4KF 00 RAINSHOWER AQUA PURE TUŠ SUSTAV S TERMOSTATOM, ZIDNA UGRADNJA

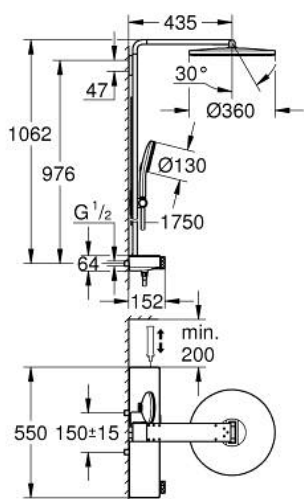

OPIS PROIZVODA (1/2)

- Colour: phantom black
- sastoji se od:
 - horizontal 435 mm shower arm
 - exposed SmartControl thermostat with metal housing
 - omogućuje promjenu između:
 - head shower Rainshower Aqua Duo round, 360 mm, black acrylic spray plate
 - swing angle 0° - 30°
 - 2 vrste mlaza:
 - GROHE PureRain, ActiveRain
 - hand shower Rainshower Aqua 130 (101 676), black acrylic spray plate
 - 3 vrste mlaza:
 - GROHE Rain, Rain+ and ActiveMassage
 - podesiv po visini uz pomoć klizača
 - initial Rainshower Aqua Pure unit (101 672 9990) enclosed
 - cijev za tuš 1750 mm
 - GROHE Rainshower Aqua Pure removes chlorine and odor (hand shower)
 - GROHE SmartTip showering spray selection via push of a ring
 - GROHE Water Saving tehnologija upotrebe manje količine vode i savršenog protoka
 - maximum flow rate (at 3 bar): 8.7 l/min
 - GROHE SmartControl with recessed metal buttons, push for ON-OFF, turn for volume adjustment from GROHE Water Saving to full flow
 - GROHE ProGrip Metal with knurl structure
 - GROHE TurboStat kompaktna kartuša s termo elementom premazanim voskom
 - GROHE SafeStop na 38°C
 - GROHE SafeStop Plus uključen opcionalan limitator temperature na 43°C
 - integrated GROHE EasyReach shower tray (black glass)
 - GROHE DreamSpray savršen mlaz
 - GROHE Long-Life premaz
 - SpeedClean sustav protiv kamenca
 - Inner WaterGuide za duži životni vijek

10 096 4KF 00 RAINSHOWER AQUA PURE TUŠ SUSTAV S TERMOSTATOM, ZIDNA UGRADNJA

OPIS PROIZVODA (2/2)

- TwistStop za zaštitu crijeva od zavrtnja
- GROHE CoolTouch prevents scalding on hot surfaces
- prikladno za protočne bojlere od 18 kW/h
- min. brzina protoka 5 l/min.
- min. preporučeni tlak 1.0 bar
- internal 6 V lithium battery (42 886 000) type CR-P2
- battery lifetime approx. 10 years
- replacement filter: Rainshower Aqua Pure unit (101 672 9990)
- optional: Rainshower Aqua glass shelf (101 677)
- to change the filter, a minimum distance of 20 cm from the right-hand side wall must be maintained